

This database was last updated on 11/16/2021 at 5:33 AM

[Return to County Website](#) | [Log Out](#)

[New Search](#) | [Back to Results](#)

Parcel Details for 018-178-28-0-10-04-002.00-0

[View GIS Map](#) | [View Tax Detail](#)

Page 1 of 1



Owner Information	Property Address
Owner's Name (Primary): CONNER,RICKY D	Address: 502 E 6th Winfield, KS 67156

General Property Information	Deed Information
Property Class: Commercial & Industrial - C Living Units: Zoning: I-1 Neighborhood: 820- Winfield Commercial NBHD Northwest Hwy 77 Corridor	Document # 976-20

Neighborhood / Tract Information	
Neighborhood:	820- Winfield Commercial NBHD Northwest Hwy 77 Corridor Block: 205 Lot: 1
Tract:	Section: Township: Range: 00
Tract Description:	CITIZEN'S ADD , BLOCK 205 , Lot 1 - 8 , ACRES 1.1
Acres:	1.10
Market Acres:	1.10

Land Based Classification System	
Function:	Warehouse-office combination
Activity:	Primarily goods storage or handling activities
Ownership:	Private-fee simple
Site:	Developed site - with buildings

Property Factors			
Topography:	Level - 1	Parking Type:	On and Off Street - 3
Utilities:	All Public - 1	Parking Quantity:	Adequate - 2
Access:	Paved Road - 1	Parking Proximity:	On Site - 3
Fronting:	Residential Street - 4	Parking Covered:	
Location:	Industrial Site - 8	Parking Uncovered:	

Appraised Values				
Tax Year	Property Class	Land	Building	Total
2021	Residential - R	00	14,380	14,380
2021	Commercial & Industrial -	19,230	67,690	86,920

Market Land Information					
Type	Method	Area or Acres	Eff. Frontage	Eff. Depth	Est. Value

Regular Lot - 1	Sqft	48000.00	00
Influence #1:		Influence #2:	Influence Override:
Factor:		Factor:	Depth Factor:

Residential Information [Information Not Available] 

Commercial Information 

Building #: 1

[View Sketch Vector](#)

Building Information

LBCS Structure Code:
Warehouse structure
Building Name: ABC PLASTICS
Identical Units: 1
of Units: 1
Unit Type:
MS Mult:
MS Zip Code:

Apartment Information

Units BR Type Baths

Apartment #1:
Apartment #2:
Apartment #3:
Apartment #4:
Apartment #5:
Apartment #6:
Apartment #7:
Apartment #8:

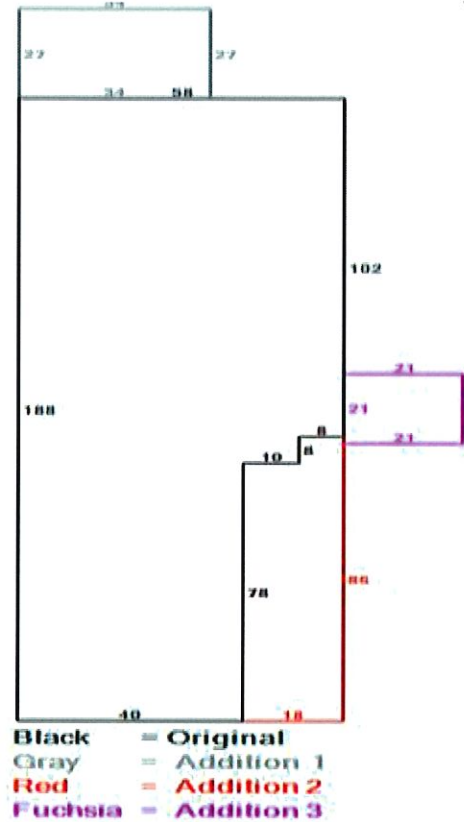

Building Sections & Basements

#	Occup	Class	Rank	MS	Year	Effective	Year	Levels	Stories	Area	Perim	Hgt	Phys	Cond	Func	Econ	Ovr	Ovr	Depr	%	MS																				
																						Reason	Use	Class	RC	NG	Good	Value													
1	Storage	Warehouse		AV1951	01	9,436	38815	FRFR					Warehouse	Commercial			9																								
																							-045										& Industrial								

Section Components

Code	Description	Unit Type	Units	Pct	Other	Rank	Year	Comment
812	Concrete Block						100	
649	No HVAC						100	
8615	Loading Dock, Concrete				918			
14005	Dock Height Floor				9,436			

2	Multiple Res (Low Rise)		AV1951	01	1,468	1119	FRFR						Residential				9				
---	-------------------------	--	--------	----	-------	------	------	--	--	--	--	--	-------------	--	--	--	---	--	--	--	--

Section Components

Code	Description	Unit Type	Units	Pct	Other	Rank	Year	Comment
812	Concrete Block						100	
606	Space Heater						100	
14005	Dock Height Floor				1,468			

3	Multiple Res		AV+1951	01	441	6317	FRFR						Residential				9				
---	--------------	--	---------	----	-----	------	------	--	--	--	--	--	-------------	--	--	--	---	--	--	--	--

(Low Rise) 01

Section Components

Code	Unit	Pct
CodeDescription	Type	Units % Other Rank Year Comment
606	Space Heater	100
812	Concrete Block	100

Building #: 2

[View Sketch Vector](#)

Building Information

LBCS Structure Code: Warehouse, prefab
 Building Name: ABC PLASTICS
 Identical Units: 1
 # of Units: 1
 Unit Type:
 MS Mult:
 MS Zip Code:

Apartment Information

Units BR Type Baths
 Apartment #1:
 Apartment #2:
 Apartment #3:
 Apartment #4:
 Apartment #5:
 Apartment #6:
 Apartment #7:
 Apartment #8:

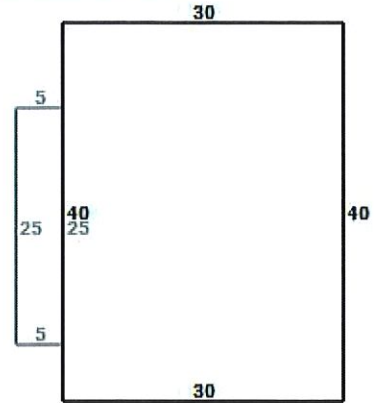

Black = Original
 Gray = Addition 1

Building Sections & Basements

MS	YearEffective	Phys	Ovr	Ovr	Depr	%	MS
#OccupClassRankBuilt	Year	LevelsStoriesAreaPerimHgtCondFuncEcon	%	ReasonUseClassRCNG	Good	Value	
1Storage Warehouse	FR+1990 / 01	1,200140 9 AVFR WarehouseCommercial - 045 & Industrial	29				

Section Components

Code	Unit	Pct
CodeDescription	Type	Units % Other Rank Year Comment
918	Single -Metal on Wood Frame	100
603	Forced Air Unit	100
8615	Loading Dock, Concrete	125
14005	Dock Height Floor	1,200

Building #: 5

: Sketch Vector Not Available

Building Information

LBCS Structure Code: Radio, TV, or wireless transmitter building
 Building Name:
 Identical Units: 1
 # of Units:
 Unit Type:
 MS Mult:
 MS Zip Code:

Apartment Information

Units BR Type Baths
 Apartment #1:
 Apartment #2:
 Apartment #3:
 Apartment #4:
 Apartment #5:
 Apartment #6:
 Apartment #7:
 Apartment #8:

Building Sections & Basements

MS	YearEffective	Phys	Ovr	Ovr	Depr	%	MS
#OccupClassRankBuilt	Year	LevelsStoriesAreaPerimHgtCondFuncEcon	%	ReasonUseClassRCNG	Good	Value	
1Equipment Shed	AV2012 / 01	30080 14 AVAV WarehouseCommercial - 045 & Industrial	62				

Section Components

Code	Unit	Pct
CodeDescription	Type	Units % Other Rank Year Comment

889	Stud -Rubble Stone	100
649	Veneer No HVAC	

Other Building Improvement Information 

Occup	MS Class	Rank	Quantity	Year Effective		LBCS	Dimensions			Phys			Ovr %	Ovr Reason	RCN LD	% Good	MS Value
				Built	Year		Area	Perim	Hgt	(L x W)	Stories	Cond					
Outbuildings	S	AV	1	1985			10	8	82 x 18	1	FR	FR			11380	2	230
Components																	
	Code	Code Description					Units	Percentage %		Area	Other	Rank	Year				
	8356						1,476			10							
Equipment (Shop) Building	S	AV	1	1987			576	11	24 x 24	1	PR	PR			18260	5	910
Components																	
	Code	Code Description					Units	Percentage %		Area	Other	Rank	Year				
	917							100									
Outbuildings	W	AV	1	2012		Communication towers/buildings	10	8	140 x 6	1	AV	AV			2503	28	700
Components																	
	Code	Code Description					Units	Percentage %		Area	Other	Rank	Year				
	8207						840										

Agricultural Information [Information Not Available] 

PROPERTY TAX INFORMATION

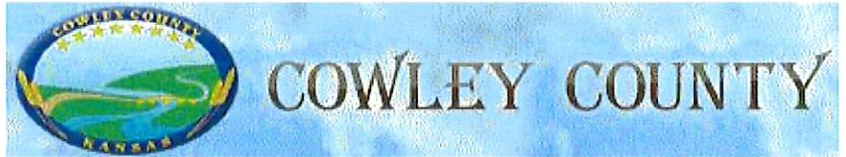

[Return To County Website](#)

[Logout](#)

Current Tax Information

Type RL **CAMA Number** 178 28 0 10 04 002 00 0 01 **Tax Identification** 010-03828
Owner ID CONN00051 CONNER, RICKY D
Taxpayer ID CONN00051 CONNER, RICKY D
 502 E 6TH 67156
Subdivision CITIZEN ADD **Block** 205 **Lot(s)** 1 **Section** 0 **Township** **Range**

[Tax History](#)
[Current Real Estate Detail](#)
[GIS Map](#)
[Print Friendly Version](#)

Year	Statement #	Line #	Warrant #	Specials Description	Specials Payoff	1st Half Due	2nd Half Due	Total Due*	1st Half Paid	2nd Half Paid
<u>2021</u>	0020097	001			0.00	2,081.33	2,081.33	4,162.66	No	No

Click on underlined tax year to see payment detail and where the tax dollars go.

* - Does not include all interest, penalties and fees.

For delinquent tax pay off amount contact Cowley County Treasurer 311 E. 9th Ave Winfield, Kansas 67156, (620) 221-5411.

[Back To Search Results](#)

[Back To Search Criteria](#)