

Russell & Buck's Addition
to the town site of
Augusta.

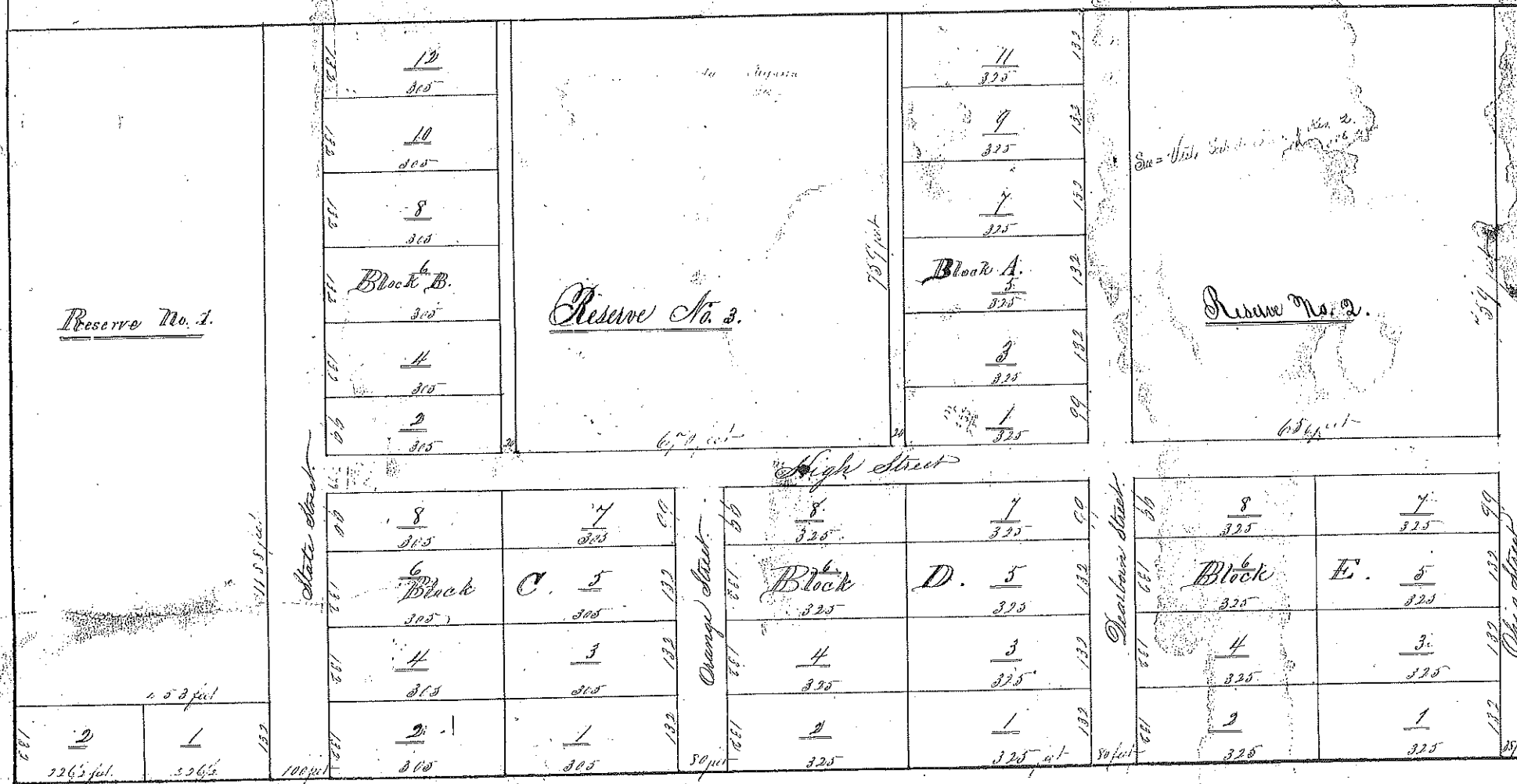

I hereby certify that the foregoing is a true description of plat of
Russell & Buck's Addition to the town site of Augusta, County of Butler
and State of Kansas as surveyed by J. R. Amel for L. E. Russell & S. A. Buck
and Reserve No. 3, surveyed by S. H. Baker, S. H. Buck,
County Surveyors.

State of Kansas, 29. This instrument was filed for records March 21st 1984
Butler County 3. 29. This instrument was filed for records March 21st 1984
at 3:30 o'clock P. M. and duly recorded in Book 417 of State at
Page 113. J. S. Knowles Register of Deeds